

Important Circular: Exhibitor e-Badge & Exhibitor Check-in Form

HKTDC Marketplace App

Your Smart Sourcing Companion



HOW TO GET YOUR EXHIBITOR E-BADGE

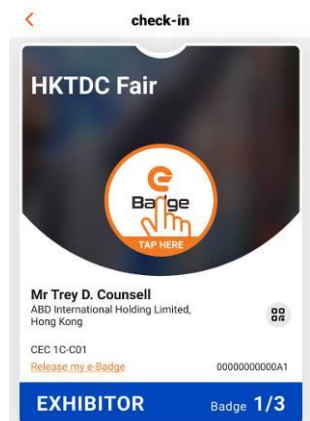
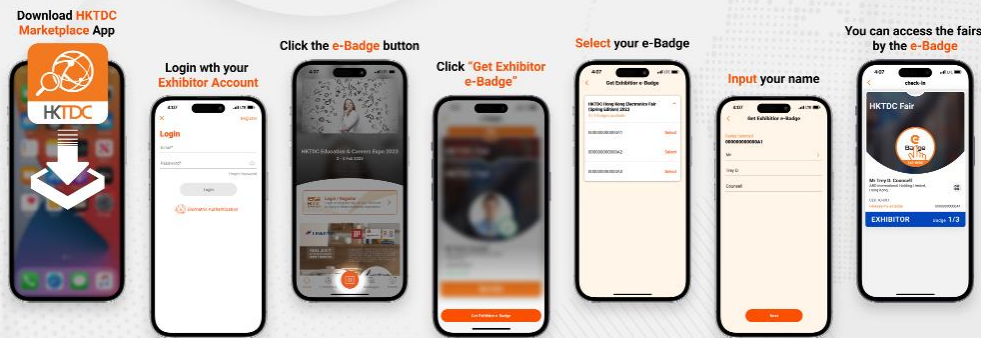

With rapid development of mobile technology and to provide the essential tools for SMEs to maximise business opportunities in the digital era, the [HKTDC Marketplace App](http://www.hktdc.com/marketplace) has been enhanced to upgrade buyer and exhibitor experience.

As part of this enhancement, we have launched the exhibitor e-Badge function within the App for a seamless fairground experience while being environmentally friendly. You are highly recommended to make use of this new feature. You and your colleagues are required to **use your own personal device to redeem your own badge** through logging in the App **with your company Exhibitor Account**.

Please redeem your own Exhibitor e-Badge and assist your colleagues on the arrangements before the move-in date (12 April).

Exhibitors are reminded that the Check-in counters are expected to be very busy on the move-in date, **so you and your colleagues are STRONGLY recommended to redeem your Exhibitor e-Badge in advance** so that you can **DIRECTLY** enter the fairground by showing your e-Badge upon arrival.

Feel free to contact us at +852-1830668, e-mail exhibitions@hktdc.org or contact the HK Electronics Fair (Spring Edition) team for further assistance.

Download on the **App Store**

GET IT ON **Google Play**

For more platform, please check:

Scan/Click the QR Code to know more

重要通告：參展商電子入場證及參展商進場登記表

香港貿發局商貿平台

您的智能流動應用程式



如何取得參展商電子入場證



隨著流動技術的快速發展，同時為了提供中小企必要的工具以增加商貿配對機會，[HKDTC Marketplace App](#)（貿發局商貿平台應用程式）已新增功能，提升買家及參展商的展會體驗。

為了令企業能夠在數碼時代把握商機，參展商現可在到達會場前透過使用 [HKDTC Marketplace App](#) 登入貴司的參展商帳號，預先換領所有參展商電子入場證（Exhibitor e-Badge）。各參展商需透過個人電子設備（手提電話、平板電腦等）以貴司的參展商帳號登入 [HKDTC Marketplace App](#) 以換領其參展商電子入場證。煩請於進館日前（4月12日）安排換領您及貴司同事的參展商電子入場證。

由於我們預計「參展商登記進場櫃位」於進館日將會非常繁忙，因此強烈建議您在進場前預先換領有關的參展商電子入場證，以便您可以在抵達時展示 e-Badge 直接進入展覽場地。

如有任何查詢，可致電+852-1830668、電郵 exhibitions@hktdc.org 或與香港春季電子產品展項目團隊聯絡。



更多下載平台，請瀏覽：



掃描或點擊二維碼
瞭解更多



Exhibitor Check-In Form

參展商進場登記表

Welcome to **HKTDC Hong Kong Electronics Fair 2025 (Spring Edition)**. Please fill in your company information below and **bring along this letter and your business card / Company Chop** to the **Exhibitor Check-in Counter** for collecting the *important on-site circulars and booth curtain**. The location and opening hours of the check-in counter are listed below.

Date : 12 April 2025 (move-in day)
Time : 9:00 a.m. – 6:00 p.m.
Location : Expo Drive Entrance
Hong Kong Convention & Exhibition Centre

We wish you every success at the Fair.

歡迎參加香港貿發局香港春季電子產品展2025。煩請貴司填妥以下資料，並攜同**此登記表及閣下名片/公司印章**於進館日到「參展商進場登記櫃位」辦理進場登記手續。貴司同時亦可領取是次展覽之重要通告及展台掛簾*。「參展商進場登記櫃位」的開放時間及地點現謹列如下：

日期 : 2025年4月12日(進館日)
時間 : 上午9時至下午6時
地點 : 香港會議展覽中心博覽道入口大堂

敬祝 貴司參展成功！

公司名稱 Company Name: _____

攤位號碼 Booth No.: _____

聯絡人 Contact Person: _____

聯絡電話 Mobile Tel: _____

簽署 Signature: _____

***Booth curtain is for standard booth, deluxe booth and premium booth only.**

***展台掛簾只供標準展台、高級展台及特級展台使用。**